

ASSEMBLING THE MIGNON NOZZLE

1. Mignon kit contents

The nozzle is supplied complete with:

- Brackets fixing and torsion spring;
- bushings set with nuts and screws attached;
- non-return valve and flexible hoses;
- 2.5 mm hex wrench;
- stainless steel cap closing the suction channel

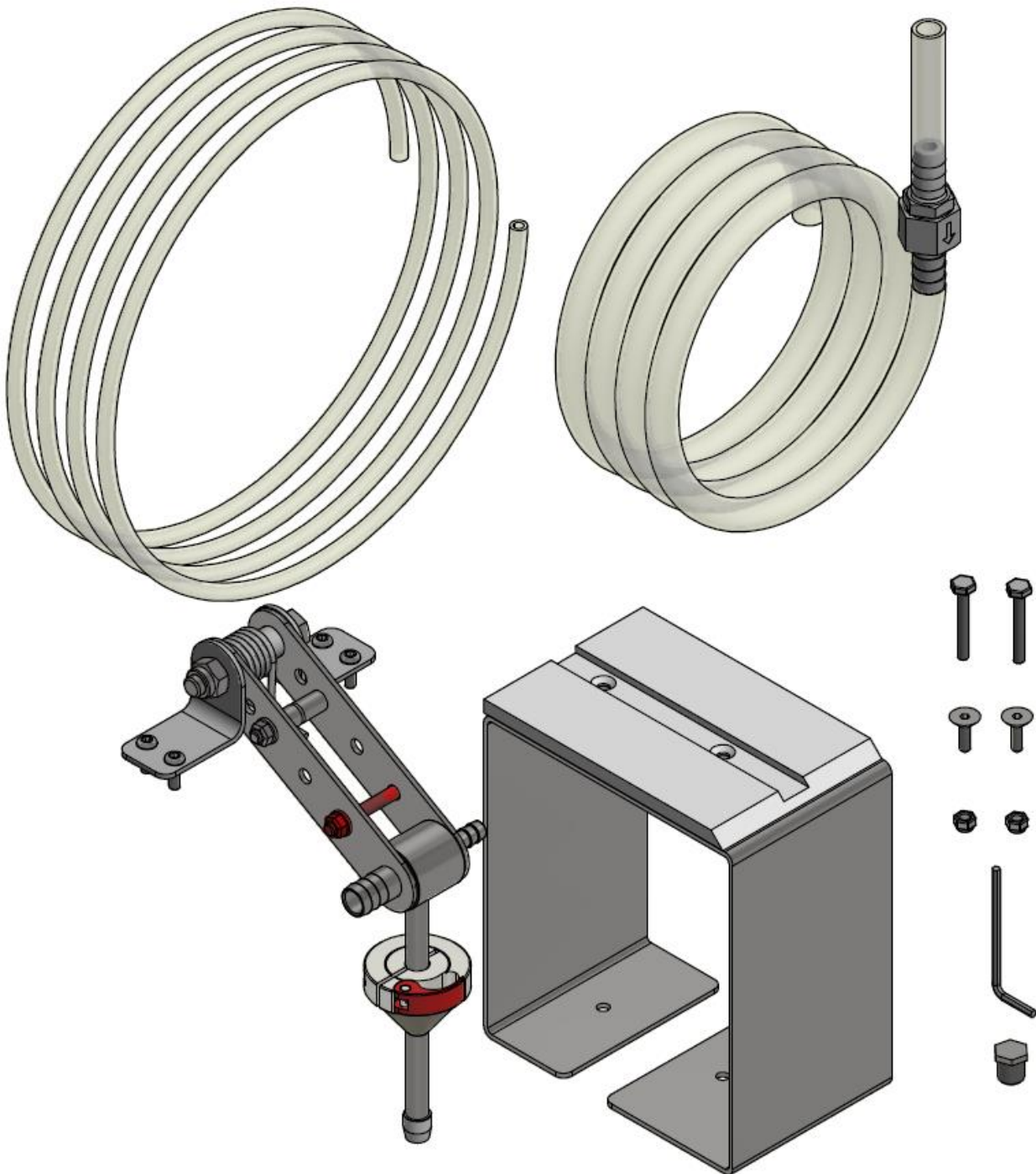
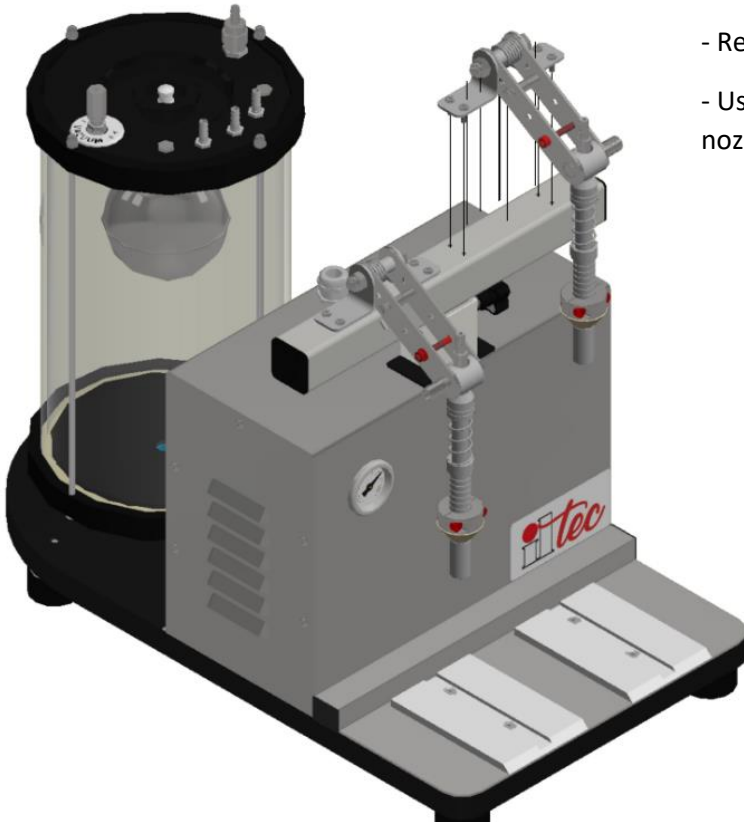
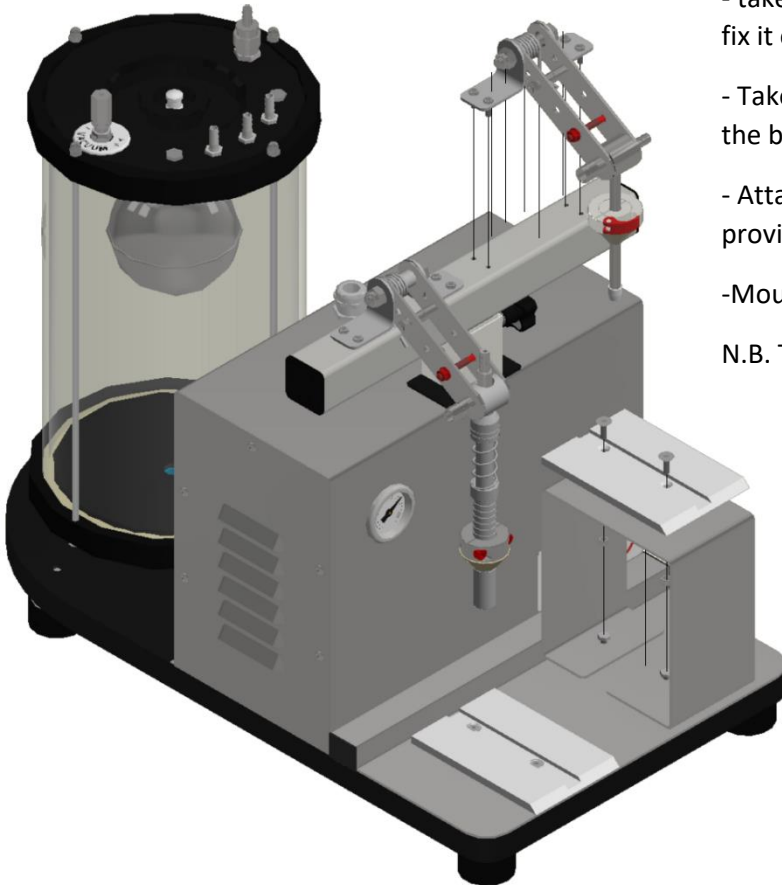

Figure 1 Kit Mignon nozzle

2. Assembling



- Remove the tubes from the nozzle you want to replace.
- Using a 2.5mm hex wrench, disassemble the fixing screws of the nozzle fixing brackets.



- take the mignon nozzle and, using the 2.5mm hex wrench, fix it on the T-beam.
 - Take care of the counterweight under the base and remove the bottle-rest plate.
 - Attach the bottle-rest plate with the screws and nuts provided to the "C" bracket.
 - Mount metal bracket to "C" with screws given in equipment.
- N.B. THE SCREWS MUST FIX ON THE UNDERWEIGHT

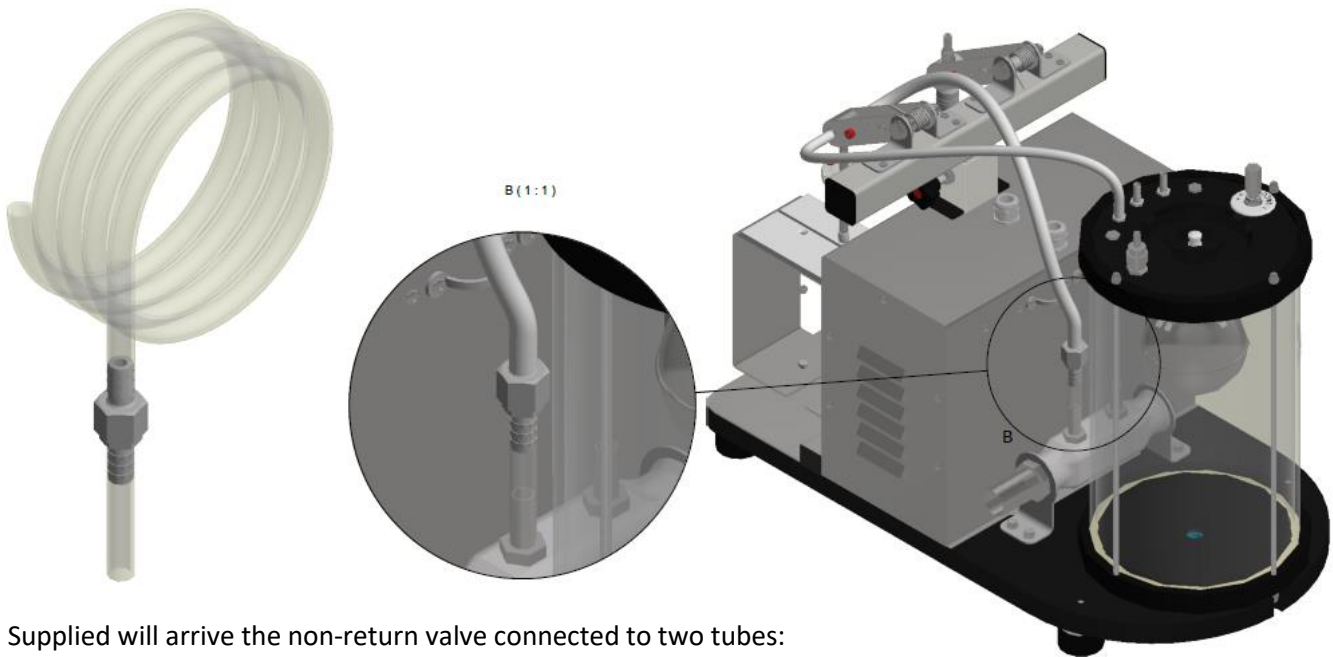

Supplied will arrive the non-return valve connected to two tubes:

- the short tube shall be connected to the collector behind the box;
- the longer tube passes through the tube stops and connects to the nozzle.

N.B. THE ARROW ON THE VALVE BODY MUST BE DIRECTED UPWARDS (as shown in the picture)

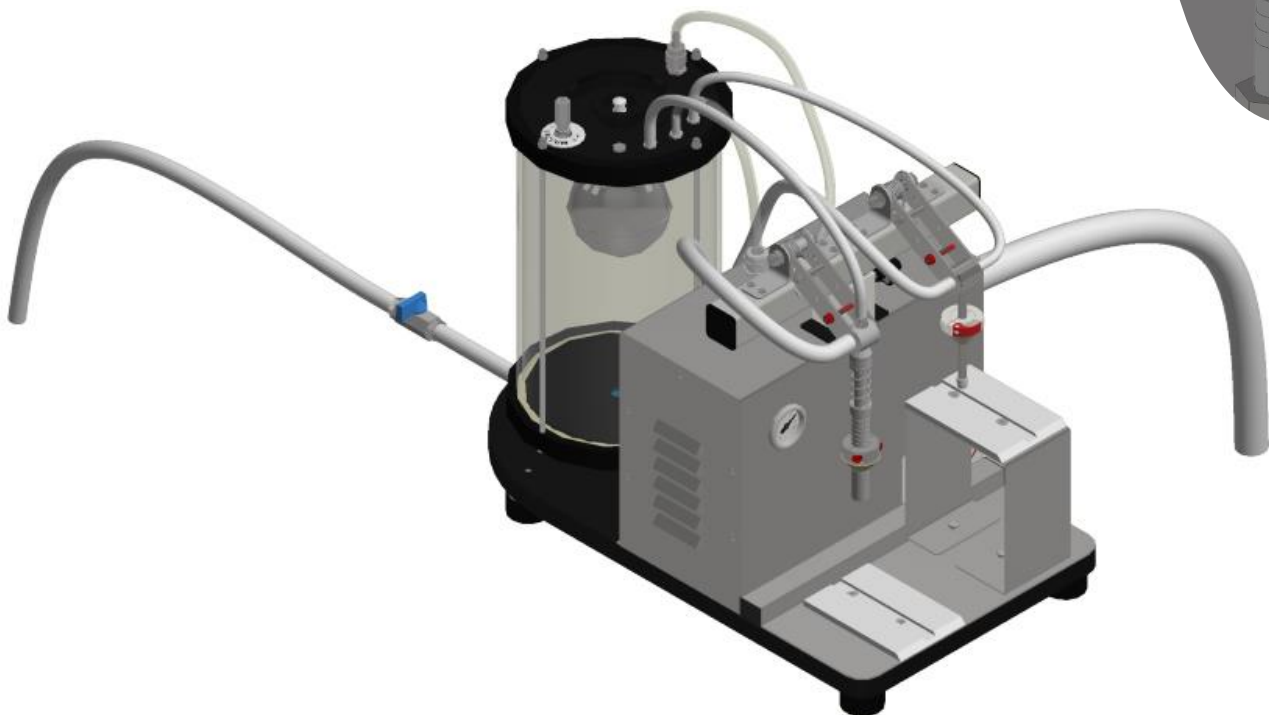

In case of use of mixed machines (with standard nozzles and mignon nozzles) and the user decides to use only the standard nozzle, a stainless steel cap is supplied to be used to increase the performance of the machine.

Example of mounting:

- 1) follow the hose from the nozzle to the hose on the tank;
- 2) Lift the removable tank cap and locate the hole on which the hose adaptor is screwed;
- 3) on the inner side of the tank cap and at the hole of the hose holder located screw the stainless steel cap (see pictures below).

